

ACTUATORS

INSTALLATION

Attention

Please read these instruction carefully before installing the actuator and retain safety for reference.

Application

The actuator is oriented to heating system and conditioning plant on zone ball valves 2÷3÷4 way.

Mode of operation

The actuator is predisposed for a ON-OFF control. The actuators has two prearranged stops running (fig.1) OPEN - SHUT, without chance to stop in other position.

Installation

Put the actuator on the valve doing attention that the valve is at the opening position, like the actuators standards, lock with the safety pin (fig.3).

Electrical connections

Electrical connections are realizable with two quadropole cable , the extremity are linked in this way:

Cable Brown	=	phase
Cable Black linked to phase	=	open valve
Cable Black not linked to phase	=	close valve
Cable Blue	=	neutral
Cable Red	=	phase exit open valve
Cable Pink	=	auxiliary switch NA (normaly open)
Cable White	=	auxiliary switch NC (normaly closed)
Cable Grey	=	auxiliary switch C (common)
Cable Purple	=	phase exit close valve

The actuator does'nt need the ground wiree because it's a II protection class.

Electrical safety note

- Check the connections before energizing the power supply
- Local accident prevention regulations should be adhered when installing the actuator
- The motor moves about slightly while it is working so it is important to use flexible leads for the electrical connections.

ATTENTION: OPENING THE COVER COMPROMISE THE PRODUCT GUARANTEE.

Manual unlock

The actuators can operate the valve manually : keep the bottom press (indicated by the arrow on the picture fig.1) and move the handle situate on the cover in the direction that you want to. Act only with hands on the handle that it's serves even as a safe stop.

- Fig.1 Actuator in the open / close position
- Fig.2 Dimensions (mm)
- Fig.3 Actuator/valve attach + safety pin
- Fig.4 - 4.5 Wiring diagram: standard - hourcount - parallel
- Fig.5 Mounting instruction

Fig. 1

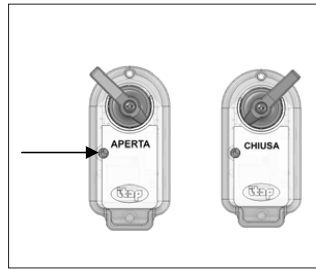

Fig. 2

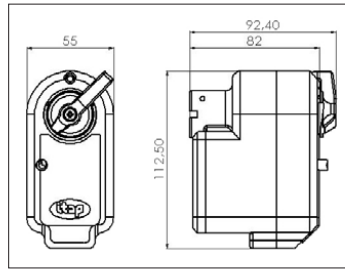

Fig. 3

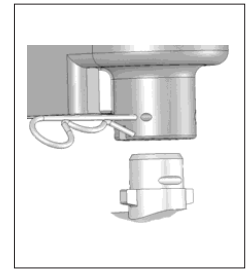

Fig. 4

WIRING DIAGRAMS ART. 990 - 991

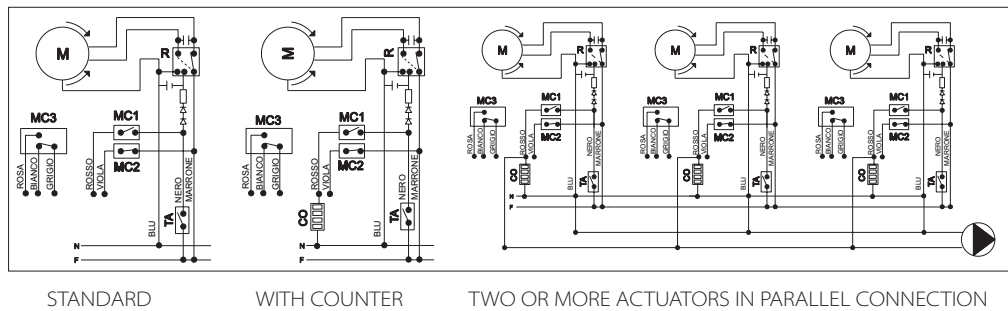

Fig. 4.5

WIRING DIAGRAMS ART. 989

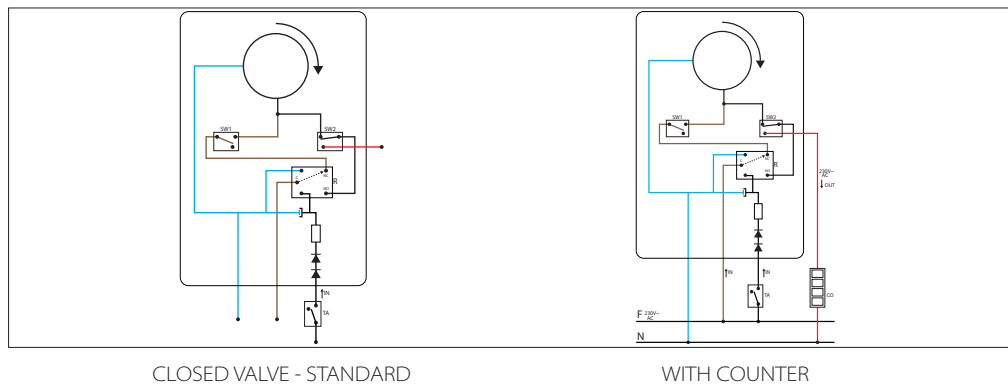

Fig. 5

